

# Acacia

2 Bedrooms / 2 Baths

1199 sq ft



Elevation A

[KerleyFamilyHomes.com](https://www.KerleyFamilyHomes.com)

\*Information believed accurate but not warranted and subject to change without prior notice. All drawings and elevation renderings are artistic representations only. Floor plan details & final decisions to be made by Kerley Family Homes. This document is for informational purposes only and is subject to change without notice. Please contact onsite agent for details regarding availability, lots and options. Updated 6.24.24



# Acacia

2 Bedrooms / 2 Baths

1199 sq ft

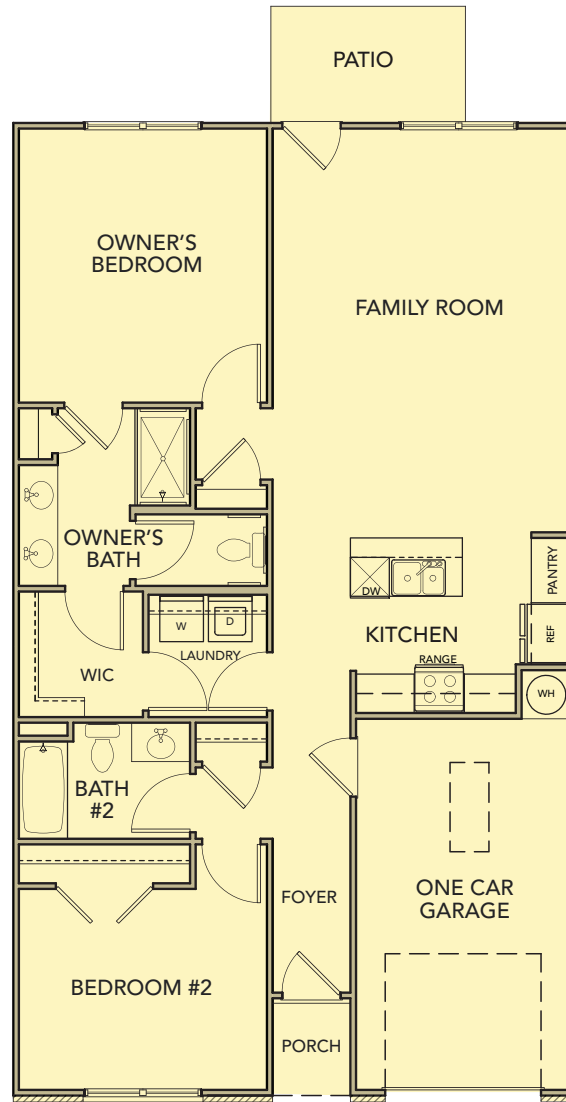

First Floor

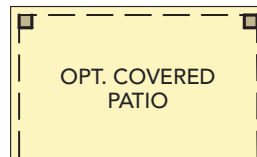

Opt. Covered Porch

